

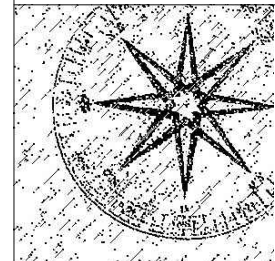

Opportunity at 203 S Greensboro

- Orange County Southern Branch Library
- Additional Space for Town of Carrboro
- Structured Parking
- Potential for Private / Public Venture
- Other



Jim Spencer Architects, PA
 103 Lloyd Street, Ground Floor
 Carrboro, NC 27510

jimspencerarchitects.com
 919.960.6680

Town of Carrboro Architectural Space Planning and Prioritization Project

203 South Greensboro Building Project

Takeaways from June 27, 2017 Board of Aldermen Meeting:

- Enthusiasm for library and other uses on site
- Primary challenge is to meet transportation needs without letting parking dictate
- Take opportunity to think big- accomplish multiple goals with project
- Create synergy between uses, but also between this project and neighboring uses
- Create good outdoor space and buildings/streetscapes with appropriate scale
- Think about how consolidation of parking can help this and other projects/uses downtown
- Bottom line costs: How to pay for larger project or more parking
- Re-think Roberson and other streetscapes to maximize access and flexibility
- Create quality architecture that fits into Carrboro's existing fabric
- Innovation in buildings/construction methods - prioritize sustainability

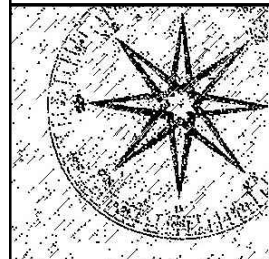

Jim Spencer Architects, PA
103 Lloyd Street, Ground Floor
Carrboro, NC 27510

jimspencerarchitects.com
919.960.6680

203 S Greensboro // June 27 Summary

Summary of Issues
Sept 19, 2017

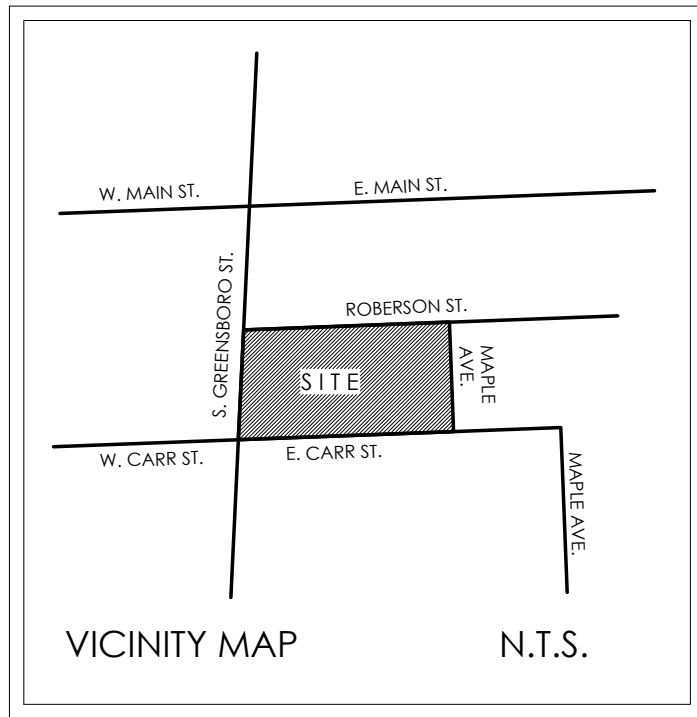

PROGRAM KEY:

	LIBRARY
	RECREATION AND PARKS
	SHARED TOWN SPACE
	TOWN LEASABLE SPACE/OTHER
	BUILDING CIRCULATION/SUPPORT
	PUBLIC OUTDOOR SPACE
	SHARED PROGRAM SPACE

SITE PLAN SCALE: 1" = 40'

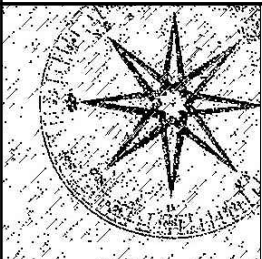

Jim Spencer Architects, PA
 103 Lloyd Street, Ground Floor
 Carrboro, NC 27510
 jimspencerarchitects.com
 919.960.6680

203 S Greensboro // Parking Deck Onsite

Parking Deck Onsite
 Sept 19, 2017

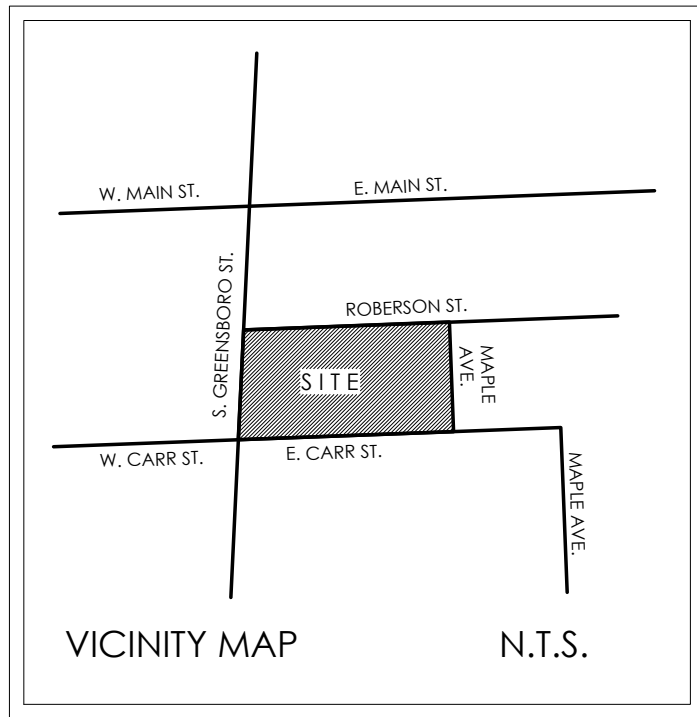

PROGRAM KEY:

	LIBRARY
	RECREATION AND PARKS
	SHARED TOWN SPACE
	TOWN LEASABLE SPACE/OTHER
	BUILDING CIRCULATION/SUPPORT
	PUBLIC OUTDOOR SPACE
	SHARED PROGRAM SPACE

SITE PLAN SCALE: 1" = 40'

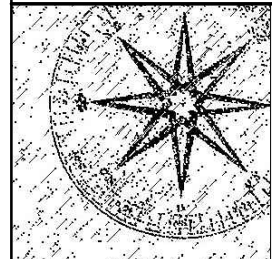

Jim Spencer Architects, PA
 103 Lloyd Street, Ground Floor
 Carrboro, NC 27510
 jimspencerarchitects.com
 919.960.6680

203 S Greensboro // Parking Deck Onsite - Underground

Parking Deck Onsite - Underground
 September 19, 2017

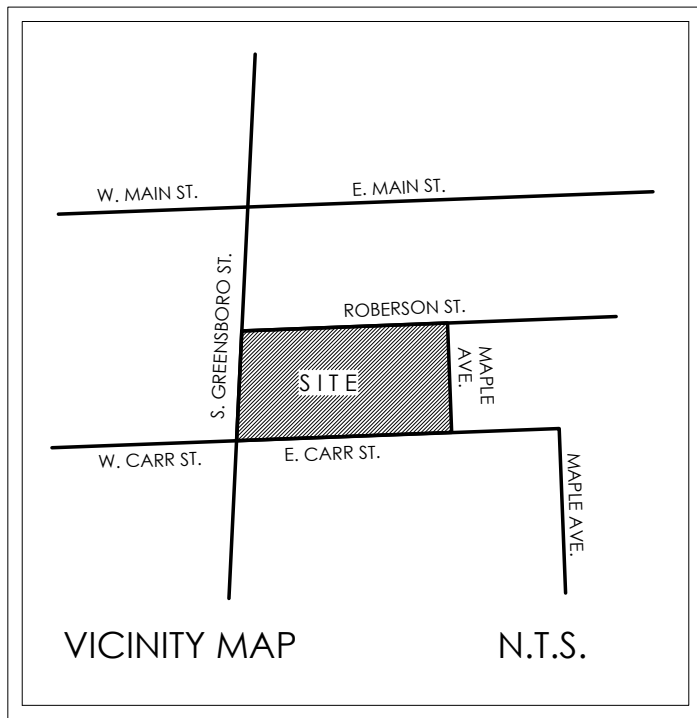

PROGRAM KEY:

	LIBRARY
	RECREATION AND PARKS
	SHARED TOWN SPACE
	TOWN LEASABLE SPACE/OTHER
	BUILDING CIRCULATION/SUPPORT
	PUBLIC OUTDOOR SPACE
	SHARED PROGRAM SPACE

SITE PLAN SCALE: 1" = 40'

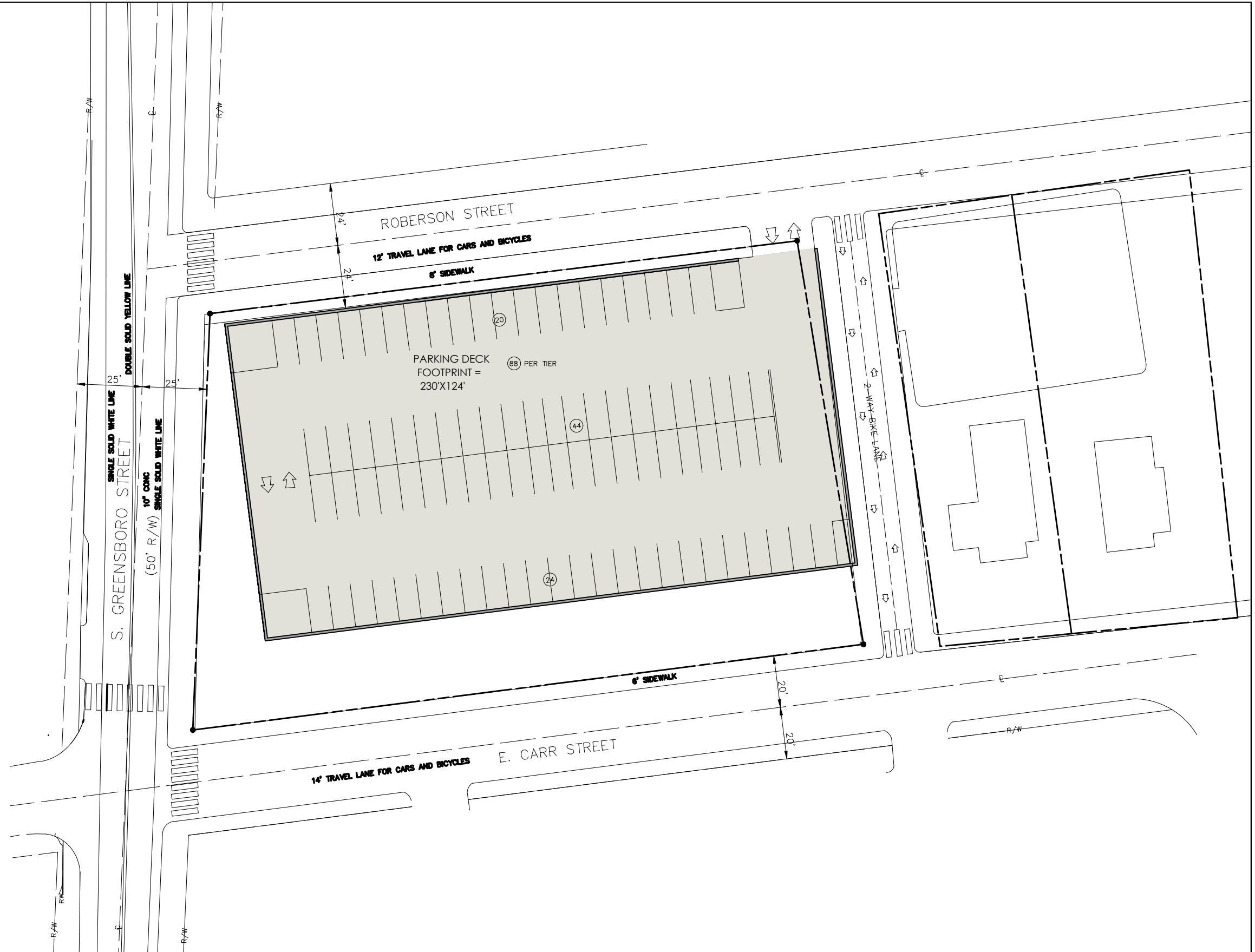



SCALE: 1:1500

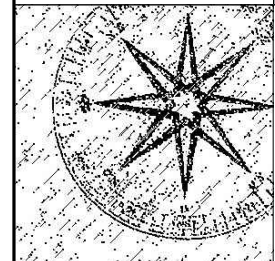

Jim Spencer Architects, PA
 103 Lloyd Street, Ground Floor
 Carrboro, NC 27510

jimspencerarchitects.com
 919.960.6680

203 S Greensboro // Remote Parking Options

Remote Parking Options
 September 19, 2017



101 Weaver Street
 Approximately 380' from 203 S Greensboro



200 S Greensboro Street
 Approximately 50' from 203 S Greensboro



201 & 203 E Carr Street
 Approximately 30' from 203 S Greensboro

SCALE: 1:1000

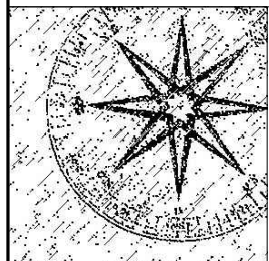

Jim Spencer Architects, PA
 103 Lloyd Street, Ground Floor
 Carrboro, NC 27510

jimspencerarchitects.com
 919.960.6680

203 S Greensboro // Remote Parking Options

Remote Parking Options
 September 19, 2017



201 Maple Avenue
 Approximately 150' from 203 S Greensboro



200 E Main Street
 Approximately 450' from 203 S Greensboro

SCALE: 1:1000

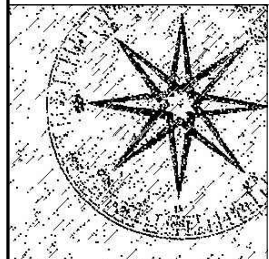

Jim Spencer Architects, PA
 103 Lloyd Street, Ground Floor
 Carrboro, NC 27510

jimspencerarchitects.com
 919.960.6680

203 S Greensboro // Remote Parking Options

Remote Parking Options
 September 19, 2017

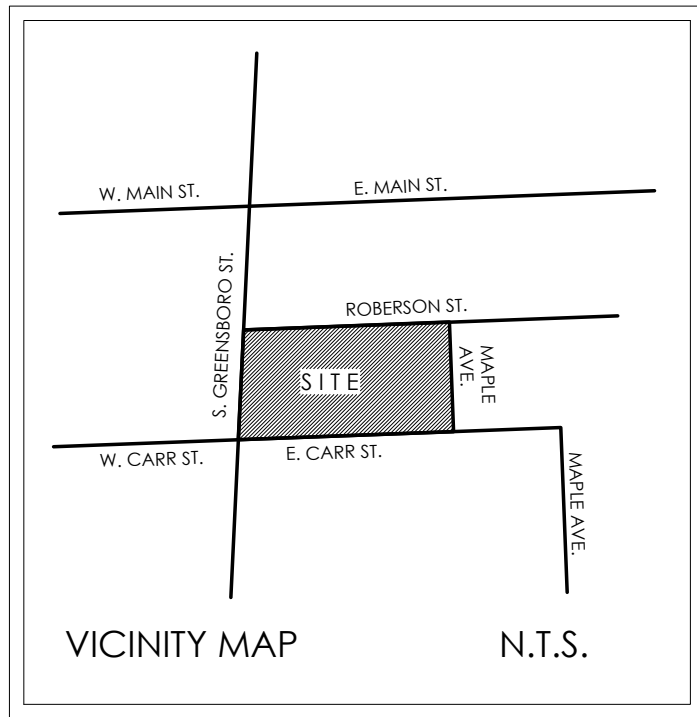

PROGRAM KEY:

	LIBRARY
	RECREATION AND PARKS
	SHARED TOWN SPACE
	TOWN LEASABLE SPACE/OTHER
	BUILDING CIRCULATION/SUPPORT
	PUBLIC OUTDOOR SPACE
	SHARED PROGRAM SPACE

SITE PLAN SCALE: 1" = 40'

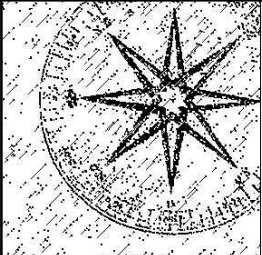

Jim Spencer Architects, PA
 103 Lloyd Street, Ground Floor
 Carrboro, NC 27510
 jimspencerarchitects.com
 919.960.6680

203 S Greensboro // Offsite Parking - Single Building

Offsite Parking - Single Building
 September 19, 2017

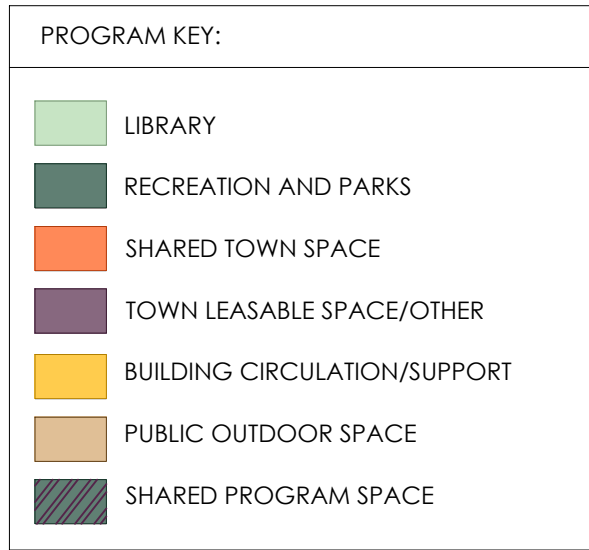
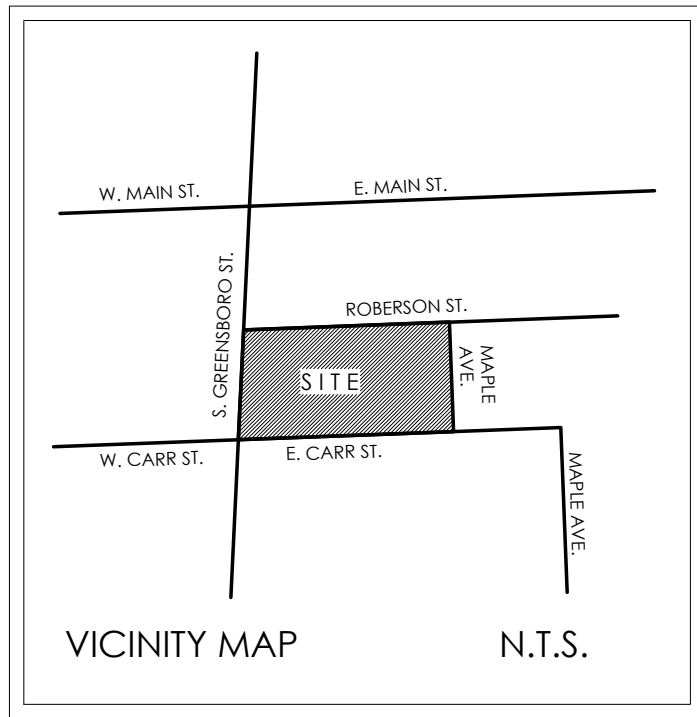

SITE PLAN SCALE: 1" = 40'

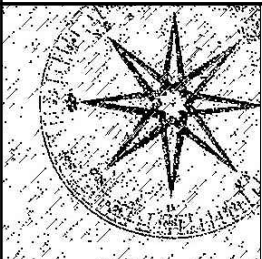

Jim Spencer Architects, PA
103 Lloyd Street, Ground Floor
Carrboro, NC 27510
jimspencerarchitects.com
919.960.6680

203 S Greensboro // Offsite Parking - Development Parcel

Offsite Parking - Development Parcel
September 19, 2017

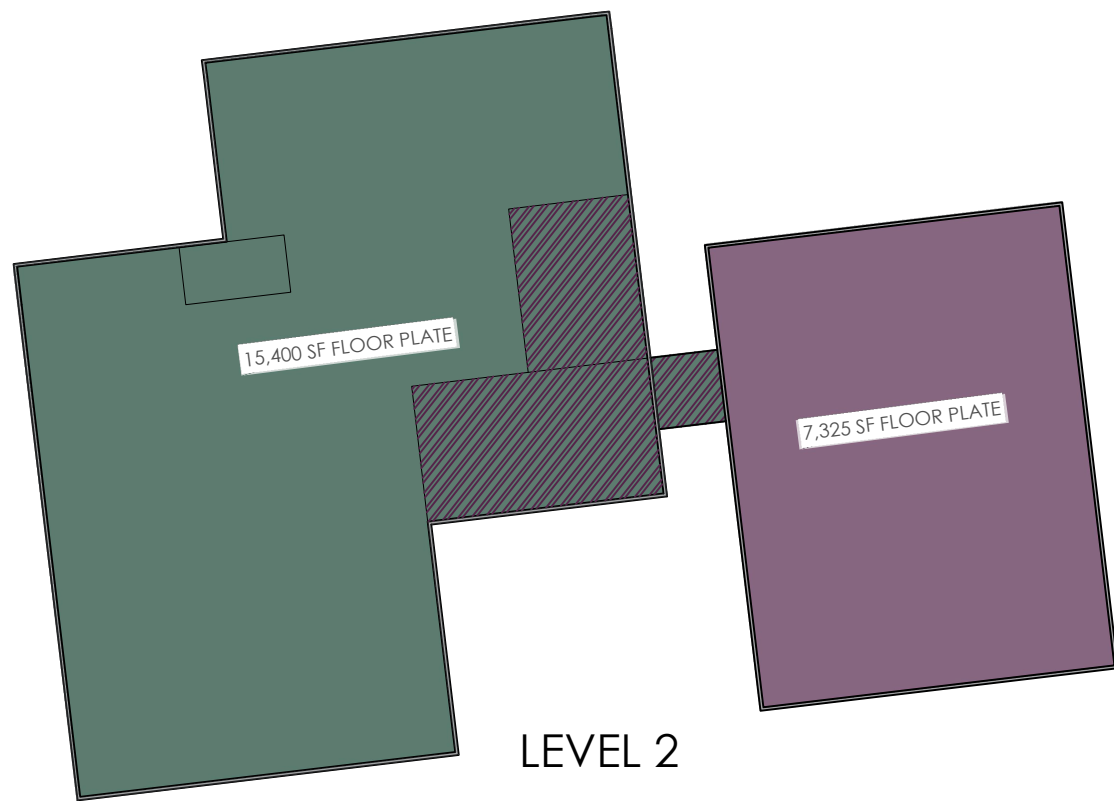
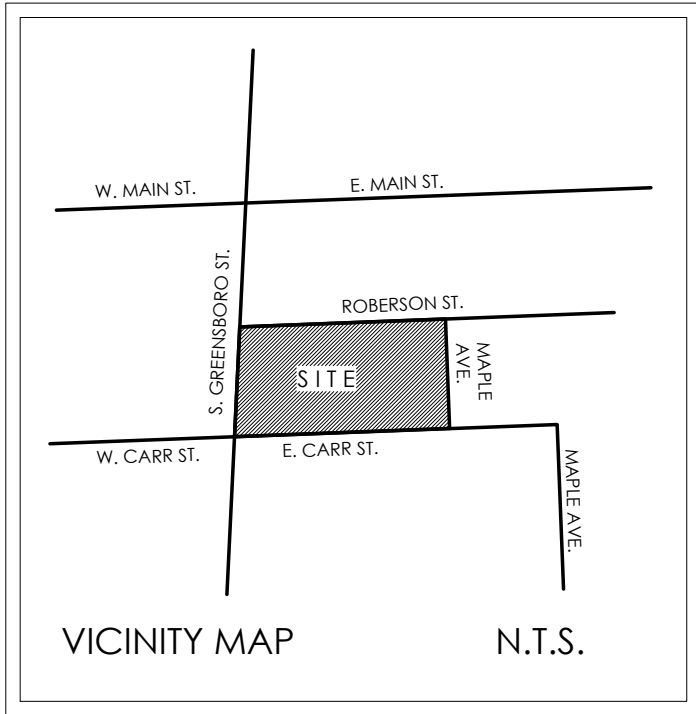

LEVEL 2

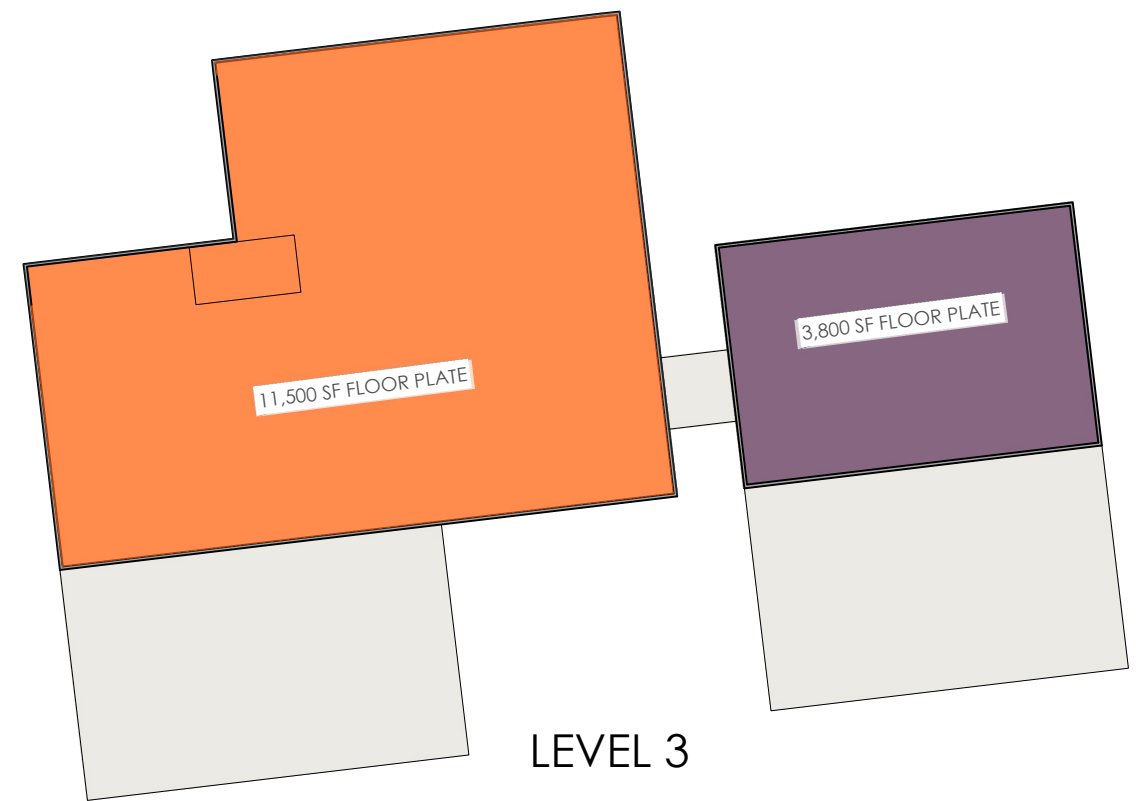

LEVEL 3

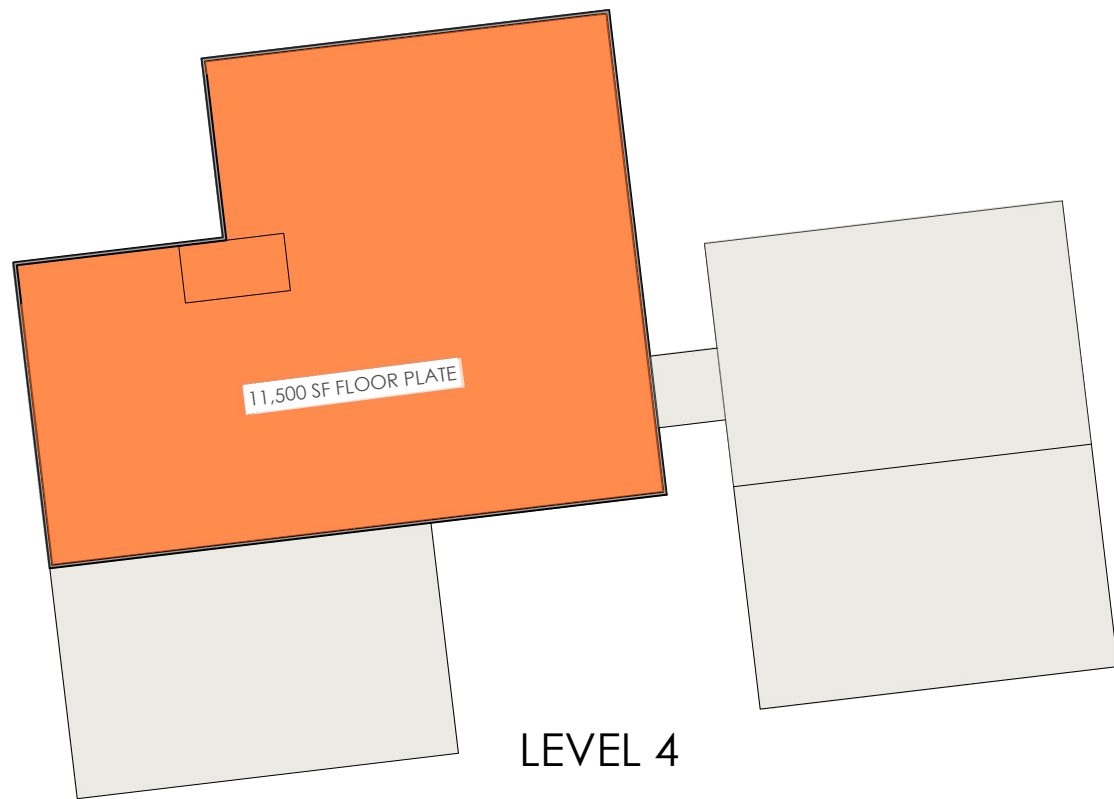

LEVEL 4

PROGRAM KEY:

	LIBRARY
	RECREATION AND PARKS
	SHARED TOWN SPACE
	TOWN LEASABLE SPACE/OTHER
	BUILDING CIRCULATION/SUPPORT
	PUBLIC OUTDOOR SPACE
	SHARED PROGRAM SPACE

SITE PLAN SCALE: 1" = 40'

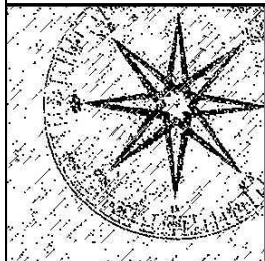

Jim Spencer Architects, PA
 103 Lloyd Street, Ground Floor
 Carrboro, NC 27510

jimspencerarchitects.com
 919.960.6680

203 S Greensboro // Offsite Parking - Development Parcel

Offsite Parking - Development Parcel
 September 19, 2017



Pedestrian Friendly Streetscape - Wall Street, Asheville NC

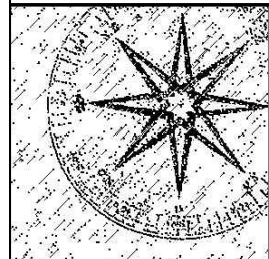
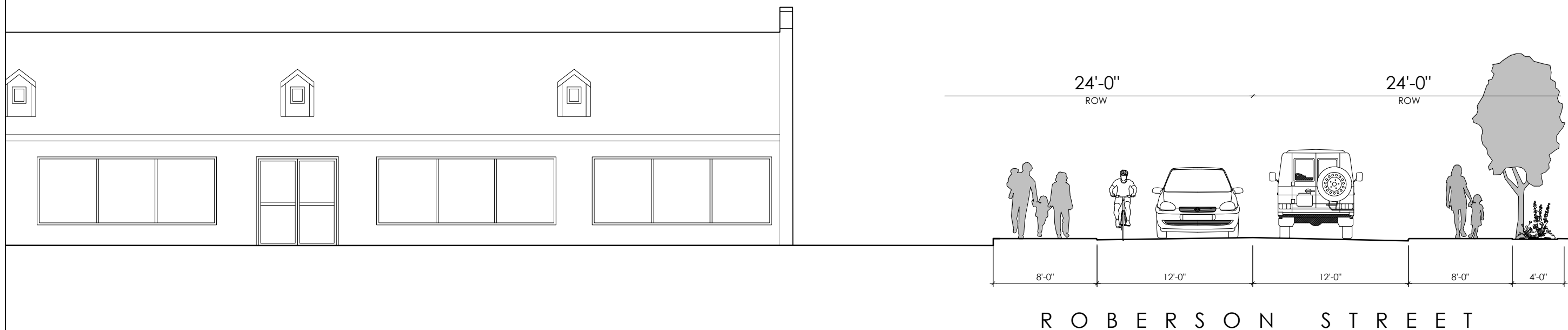

Jim Spencer Architects, PA
 103 Lloyd Street, Ground Floor
 Carrboro, NC 27510
 jimspencerarchitects.com
 919.960.6680

203 S Greensboro // Reimagining Roberson Street

Reimagining Roberson Street
 September 19, 2017

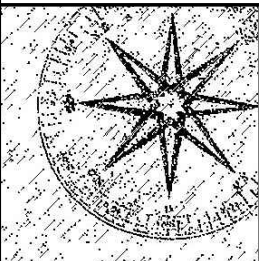
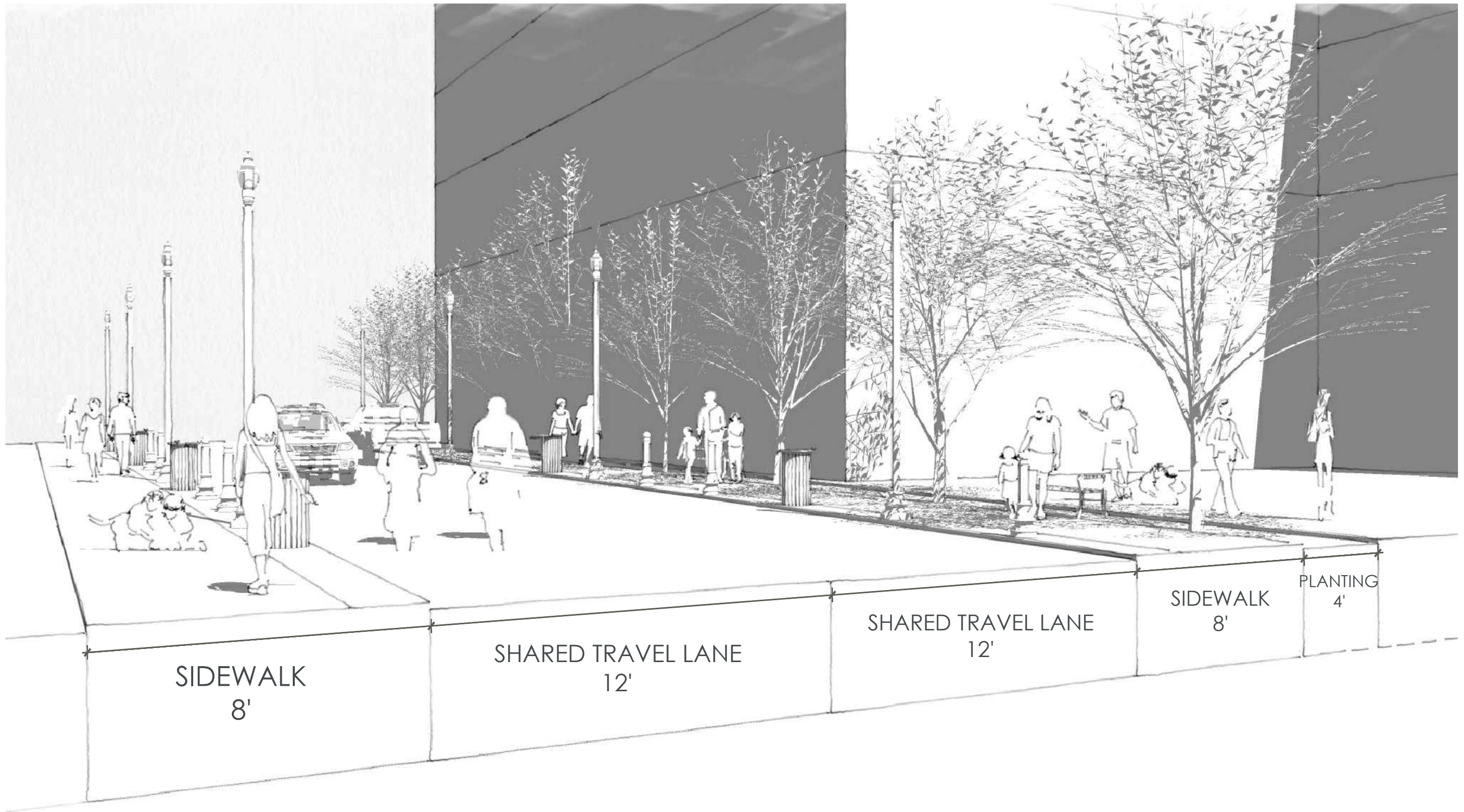

Jim Spencer Architects, PA
 103 Lloyd Street, Ground Floor
 Carrboro, NC 27510

jimspencerarchitects.com
 919.960.6680

203 S Greensboro // Reimagining Roberson Street

Reimagining Roberson Street
 September 19, 2017

**Town of Carrboro Space Planning and Prioritization Project
203 South Greensboro Building Project**

**Original Site Plan - Parking Deck On Site Option
(Building Program of Approximately 55,000 SF, Parking for 300 Vehicles)**

Potential Advantages:

- Utilizing site already owned by Town of Carrboro
- Compact, dense site plan with all program elements on site
- Generally meets the Town of Carrboro ordinances/comprehensive plans
- Ample parking for program requirements + additional uses/other projects

Potential Disadvantages :

- Parking driving site design - large deck near neighborhood
- Building Footprint dictated by remaining square footage on site - (L-shaped plan)
- Quality of building - light and access to site
- Lack of outdoor /public space

**Parking Deck On Site - Underground Parking Option
(Building Program of Approximately 55,000-70,000 SF, Parking for 180-200 Vehicles)**

Potential Advantages:

- Parking hidden on site - allows more contiguous footprints and more public/outdoor spaces
- De-emphasizes the car and emphasizes other modes of accessing the site (pedestrians/bikes/bus)
- Generally meets the Town of Carrboro ordinances/comprehensive plans
- Also contained on existing Town of Carrboro property

Potential Disadvantages :

- Quality and quantity of parking - underground environment and fewer spaces unless 3 tiers underground
- Potentially very expensive sub-grade and building construction (also mechanical exhaust/sprinkler)
- Unknowns of sub-grade work - reference potential costs/complications of subsurface report

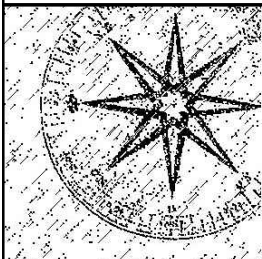

Jim Spencer Architects, PA
103 Lloyd Street, Ground Floor
Carrboro, NC 27510

jimspencerarchitects.com
919.960.6680

**Town of Carrboro Space Planning and Prioritization Project
203 South Greensboro Building Project**

**Off Site Parking - Single Building Option
(Building Program of Approximately 55,000-70,000 SF, Parking for 300 Vehicles)**

Potential Advantages:

- Parking consolidated for 203 and potentially other uses
- More open site plan - with open multi-use public and outdoor space
- Generally meets the Town of Carrboro ordinances/comprehensive plans
- Quality of building space - more daylight, easier construction and upfit with more contiguous footprints
- Quality of and scale of downtown environment

Potential Disadvantages :

- Additional cost and complication of acquiring other parcels and development of separate parcels
- Limits of potential building and open space by parking space counts and distance
- Quantity of Accessible/Convenience Parking

**Off Site Parking - Development Parcel Option
(Building Program of Approximately 55,000-70,000 SF, Parking for 180-200 Vehicles)**

Potential Advantages:

- Potential revenue/development opportunity which may be taken advantage of now or in future
- More open site plan - with open multi-use public and outdoor space
- Generally meets the Town of Carrboro ordinances/comprehensive plans
- Quality of building space - more daylight, easier construction and upfit with more contiguous footprints
- Quality of and scale of downtown environment

Potential Disadvantages :

- Additional cost and complication of acquiring other parcels and development of separate parcels
- Potential need to control type of uses and synergy between parcels on one small site

