

-----Original Message-----

From: Bruce Runberg [<mailto:brunberg17@gmail.com>]

Sent: Monday, April 01, 2019 4:04 PM

To: boa

Cc: Catherine Dorando; David Andrews; <jimmeritt@nc.rr.com>; Lee Heavlin; David Chandler

Subject: Orange County Veterans Memorial Funding Request

Dear Board Members,

Jim Merritt and I are Co-Chairs of the Veterans Memorial, We came before you on 8 January 2019 and requested your support in providing \$25k to this important project. We left several of our brochures with you and the Manager. And your Barbara Foushee is now an active member of our Committee. We believe the project was well received!

We understand you are in the midst of budget discussions. By this email, we formally request the donation of \$25k to our extremely worthwhile project. The Memorial is currently open with paths, a temporary flagpole, and a temporary kiosk, constructed under our first phase. It is located in a beautiful 3 acre site full of oaks near the Seymour Senior Center off Homestead Road. It will be a place of beauty, reflection, historical information, education; open to everyone. I have attached a copy of our design by David Swanson for the 2nd phase. There will be 2 or 3 more phases to complete the work. We are also requesting funds from other local Towns and the County, based on proportional size. We are making good headway there. I would add that there are over 6,000 veterans in Orange County we can serve.

Many thanks for your consideration of this request.

Jim Merritt and Bruce Runberg, Co-Chairs of the Orange County Veterans Memorial

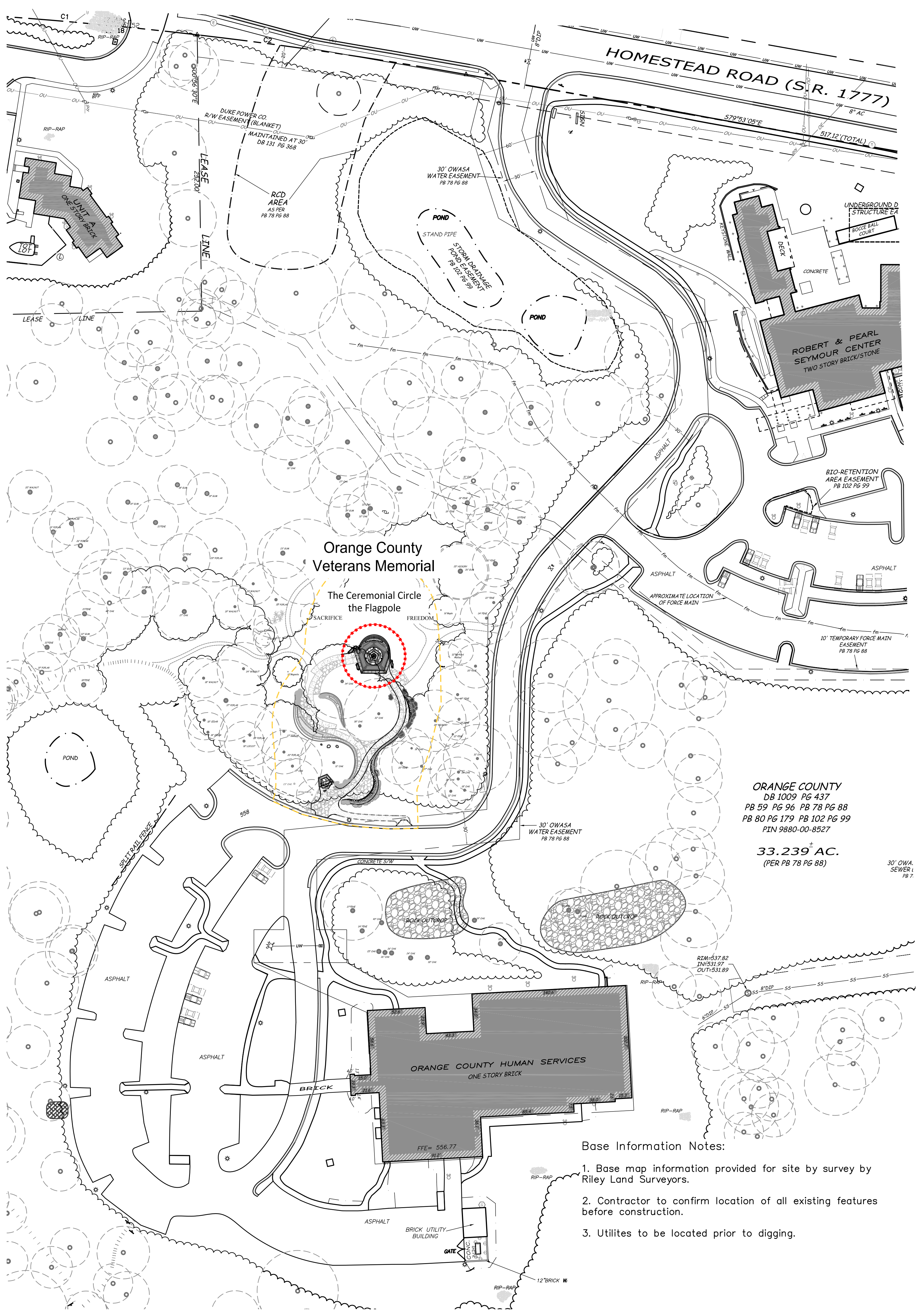

Base Information Notes:

1. Base map information provided for site by survey by Riley Land Surveyors.
2. Contractor to confirm location of all existing features before construction.
3. Utilities to be located prior to digging.



Veterans Memorial showing views with future buildout



Veterans Memorial Model (by Dan Hassell)

- LIST OF DRAWINGS
- L - 1.0 Cover Site Context Project Summary
 - L - 1.1 Existing Conditions (1"=10' scale)
 - L - 2.0 Site Plan (1"=10' scale)
 - L - 2.1 Grading Plan Erosion Control (1"=10' scale)
 - L - 3.0 Detail Ceremonial Circle Plan Details
 - L - 3.1 Details

- GENERAL NOTES:
- Pre-Construction:
1. Location of staging area will be identified during the pre-bid conference. The existing parking area off Southern Human Service Center Drive will be used for access and construction parking for the site during the time period outlined in Note 4. Other times will be the responsibility of the contractor to determine access to site and construction parking and staging of materials.
 2. PROPOSED SCHEDULE: Contractor shall bring in all necessary construction materials between XX and XX.
 3. Contractor shall verify all existing conditions and dimensions in the field.
 4. Contractor to coordinate with Orange County Southern Human Services and Utility Locating Service to verify locations of underground utilities and easements.

GENERALIZED SCOPE OF PROJECT
BASE BID: By Contractor

- Pre-Construction:
- Install construction management signs (By Contractor)
 - Install Tree Protection Fencing (By Contractor)
 - Provide Silt Fencing during Construction. (By Contractor)

- New Construction:
- Construct Memorial Stone Wall and associated boulder rocks. (By Contractor)
 - Grading and drainage work to swale around the ceremonial circle. Extend existing drain pipe and make drainage improvements and catch basin as indicated.
 - Install stone paving and concrete pavers (including donor pavers).
 - Install bluestone border and medallions as shown.
 - Install Flagpole and associated hardscape.
 - Install Landscape Lighting to uplight flagpole.
 - Clean job site of construction materials upon completion of Hardscape Improvements. (By Contractor)

- BY OTHERS - Orange County (OWNER):
- Remove selected trees (dead or dying or in way of construction). Thin and prune and tree management for existing trees to remain.
 - Provide electrical stub to site from existing meters and electric transformer at Southern Human Services site.
 - Provide site furnishings (site benches as shown, signage and trash containers).

SWANSON
and ASSOCIATES P.A.
LANDSCAPE ARCHITECTURE
100 E. Carr Street
Carrboro, NC 27510
Ph. (919) 929-9000
info@swansonlandscapearchitecture.com

Danny W. Hassell, LTC
(ret), U.S. Army
ArcLand Designs, L.L.C.

Orange County Veterans Memorial

Orange County
Southern Human
Services Center

Homestead Road
Chapel Hill, NC

April 20, 2018

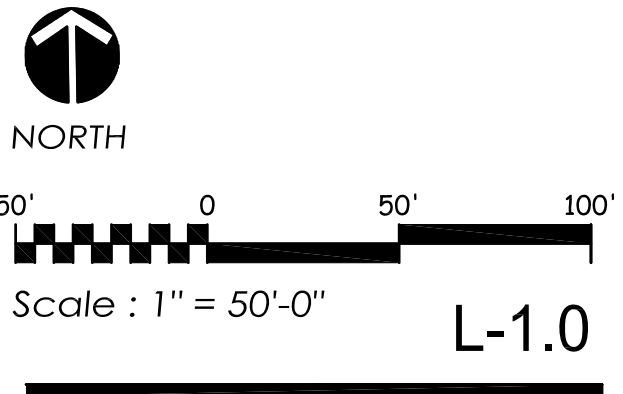

Orange County Veterans Memorial

The Ceremonial Circle the Flagpole

SACRIFICE FREEDOM

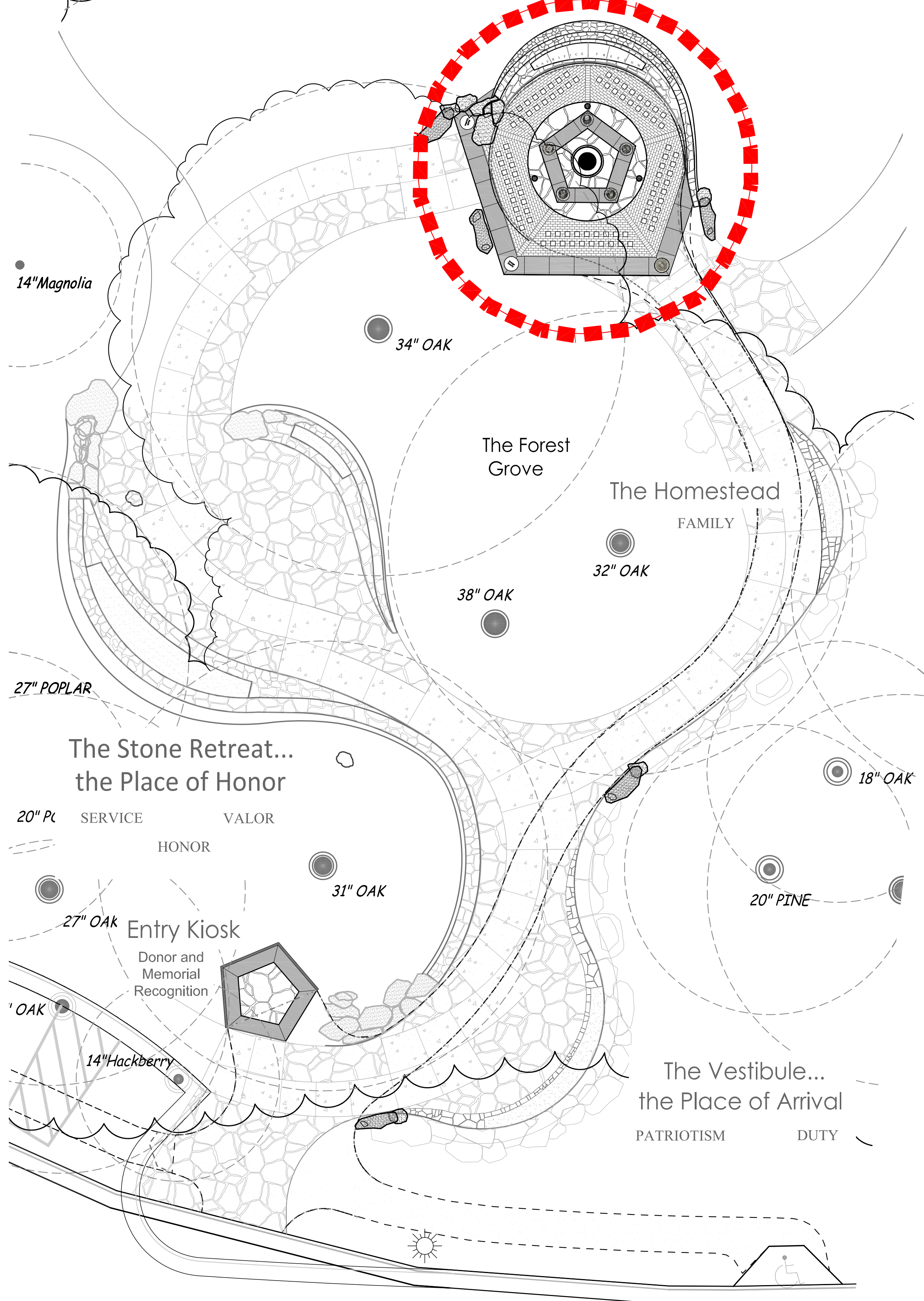

Site Plan showing Phase 2 with Future Buildout

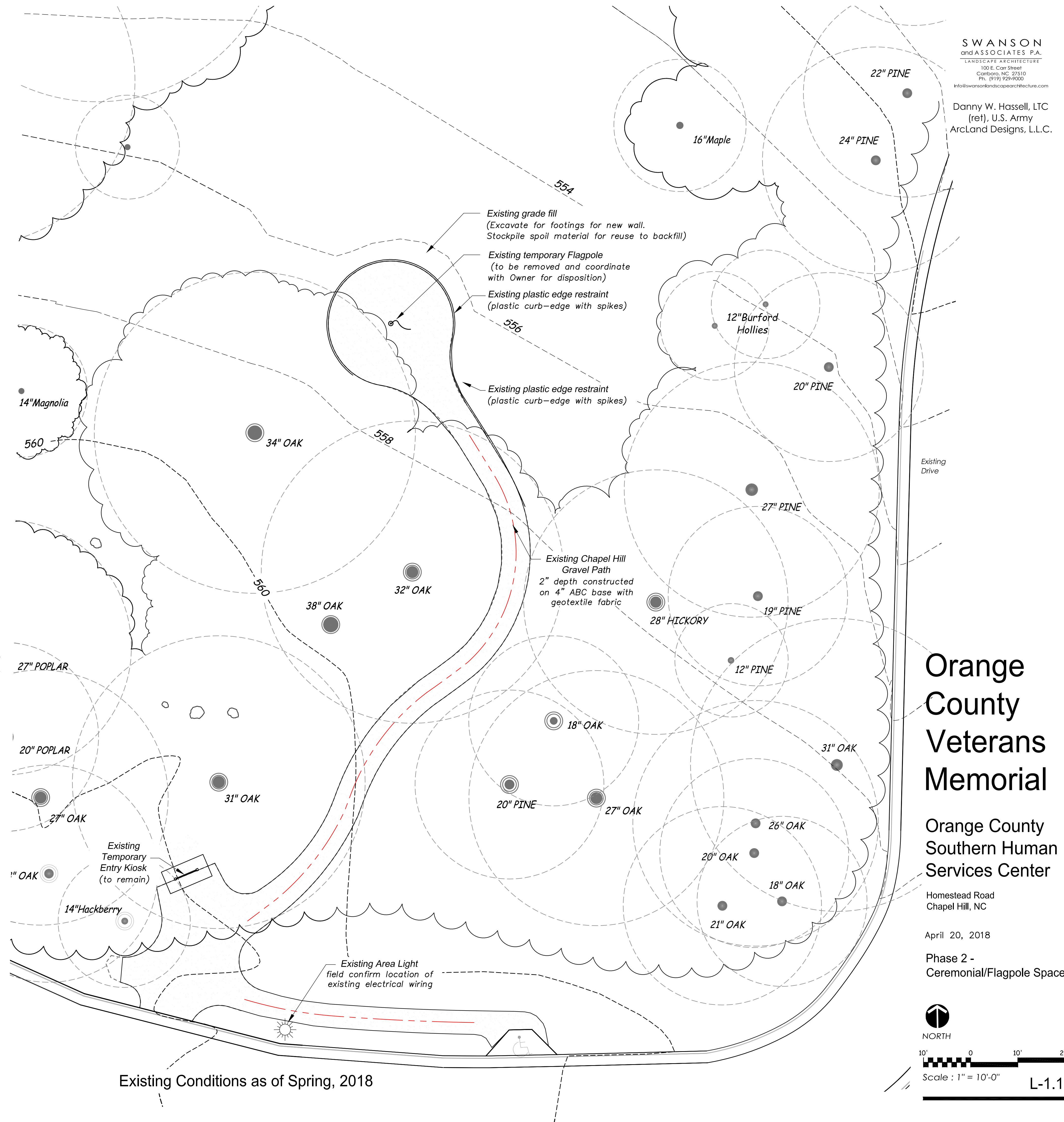

Existing Conditions as of Spring, 2018

SWANSON
and ASSOCIATES P.A.
LANDSCAPE ARCHITECTURE
100 E. Carr Street
Carrboro, NC 27510
Ph. (919) 929-9000
info@swansonlandscapearchitecture.com
Danny W. Hassell, LTC
(ret), U.S. Army
ArcLand Designs, L.L.C.

Orange County Veterans Memorial

Orange County
Southern Human
Services Center

Homestead Road
Chapel Hill, NC

April 20, 2018

Phase 2 -
Ceremonial/Flagpole Space



Scale : 1" = 10'-0"
L-1.1

Danny W. Hassell, LTC
(ret), U.S. Army
ArcLand Designs, L.L.C.

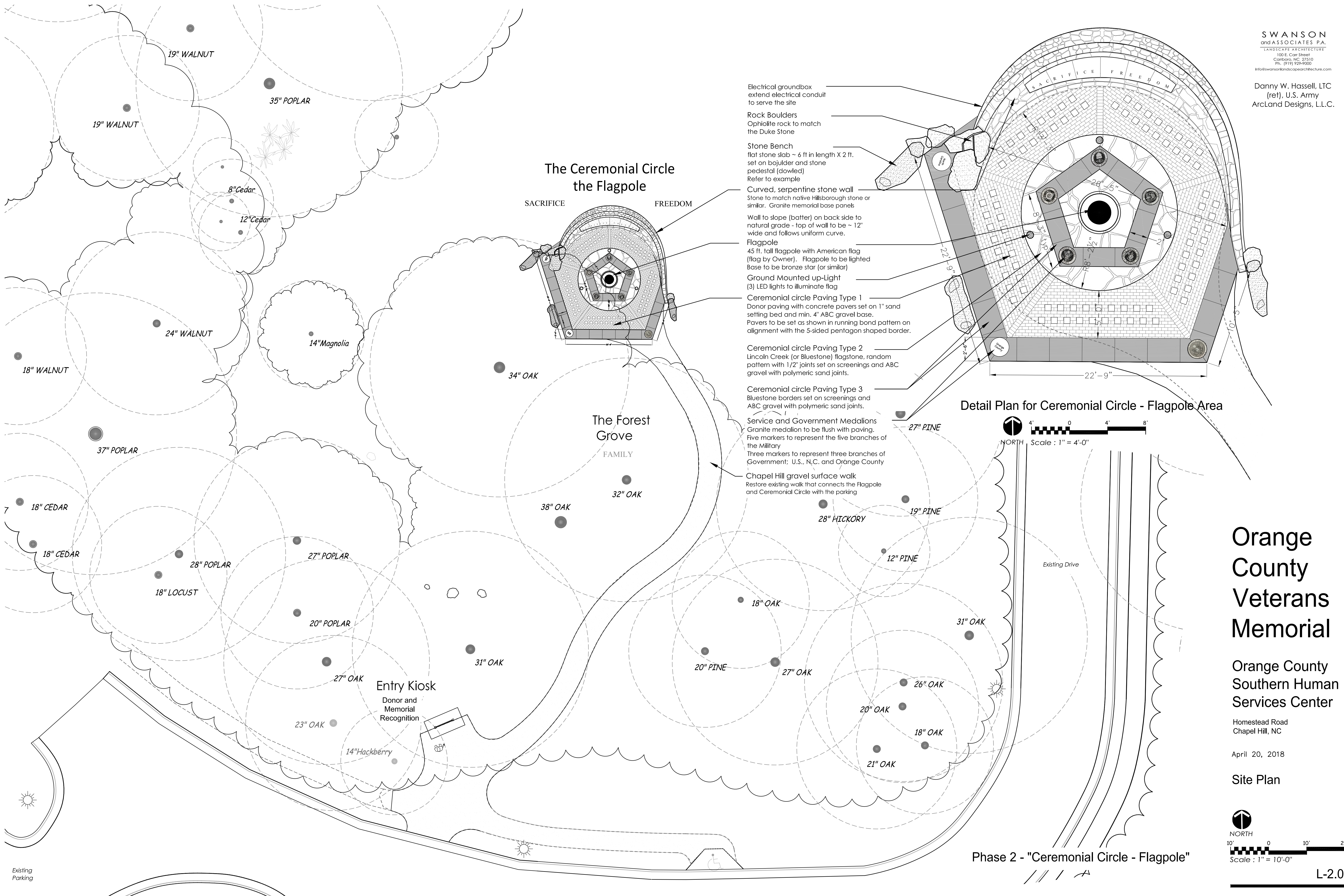

Orange County Veterans Memorial

Orange County
Southern Human
Services Center

Homestead Road
Chapel Hill, NC

April 20, 2018

Site Plan

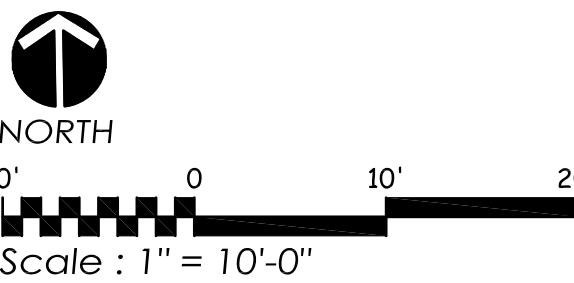

Site Work Guidelines

The tree protection fencing and silt fencing should be installed prior to deconstruction, demolition and the grading operations and continue until all major construction and utility work has been completed.

Contact appropriate utility companies and protect existing utility connections.

Tree Protection Notes

- Any tree roots exposed by construction shall be severed cleanly with a pruning tool.
- Do not dispose of any chemicals or remove soil outside the limit of work.
- When installing new landscape plants, do not drive equipment upon or disturb the soil within the critical root zone of existing trees.
- A preconstruction conference must be held before any site work begins.

Construction Sequence

- Obtain appropriate permits.
- Hold preconstruction conference.
- Erect tree protection fencing—flagging before substantial work with any equipment an/or utility work. Install soil and erosion control measures.

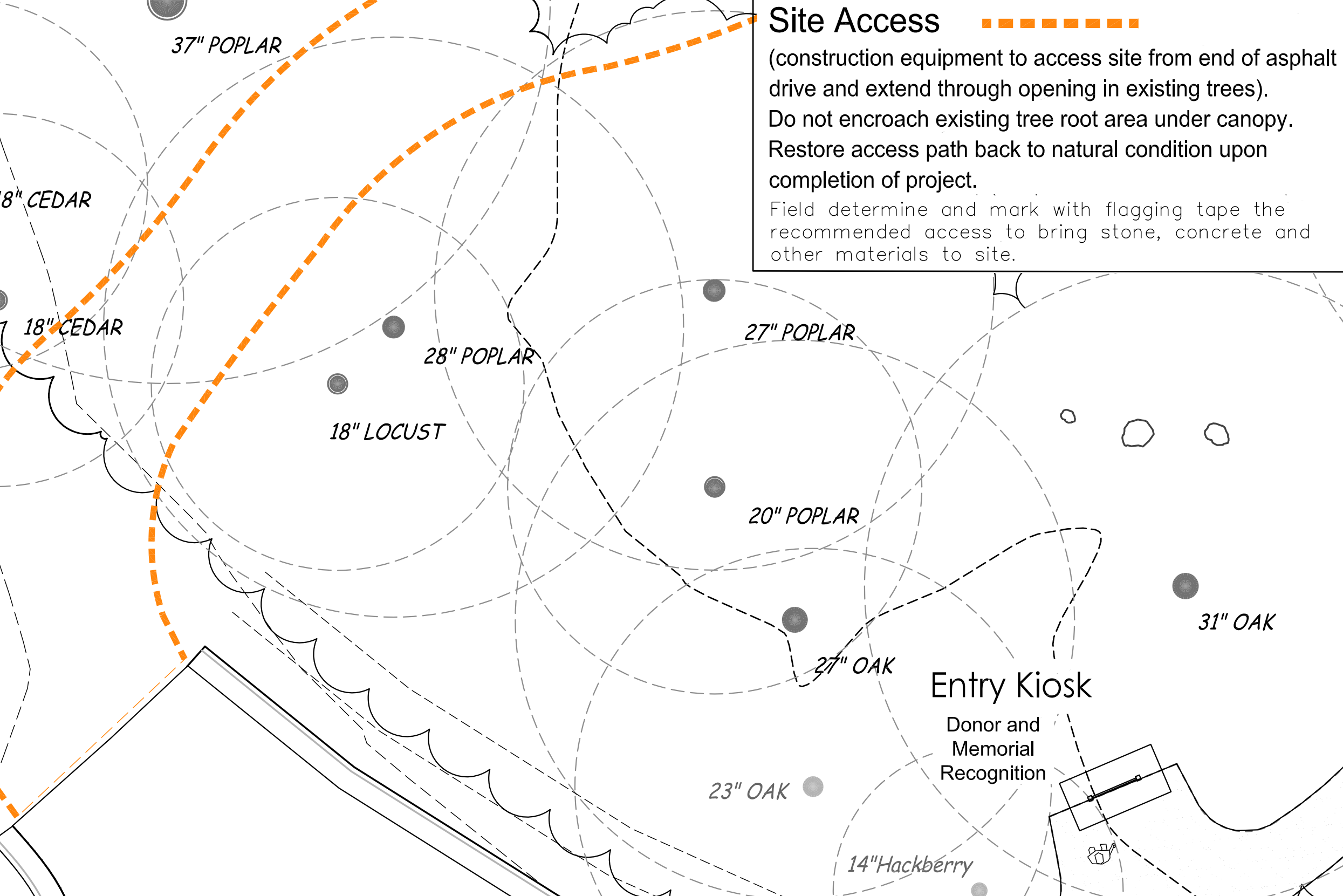
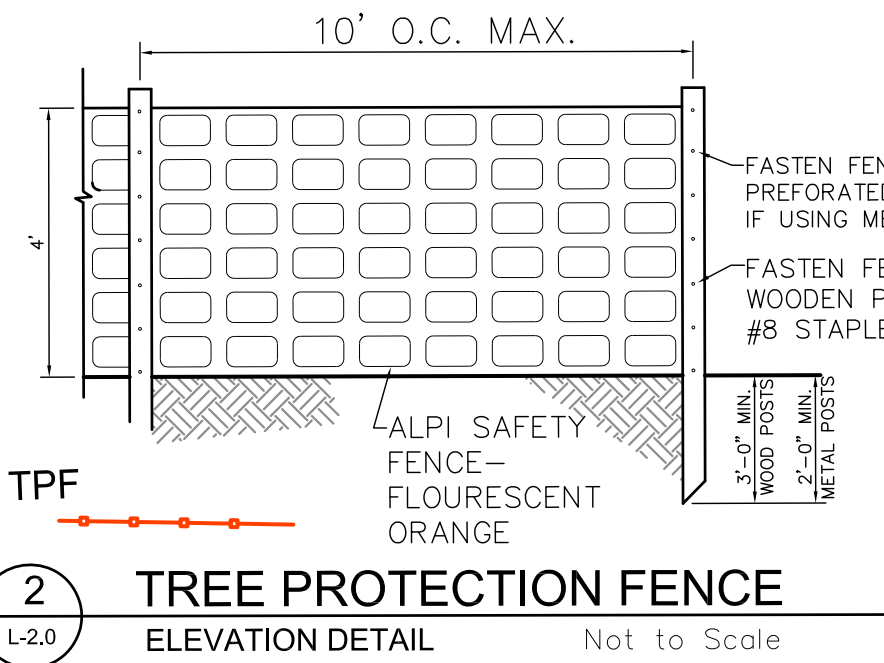

Site Access

(construction equipment to access site from end of asphalt drive and extend through opening in existing trees). Do not encroach existing tree root area under canopy. Restore access path back to natural condition upon completion of project.

Field determine and mark with flagging tape the recommended access to bring stone, concrete and other materials to site.

Do not use existing Chapel Hill gravel walk for construction access. Any damage to existing walk to be repaired.

Grading intent

build up this area so the flagpole base is ~ elev 558 and pavement slopes in all directions away from the flagpole and around sides of stone wall at 2% slope.

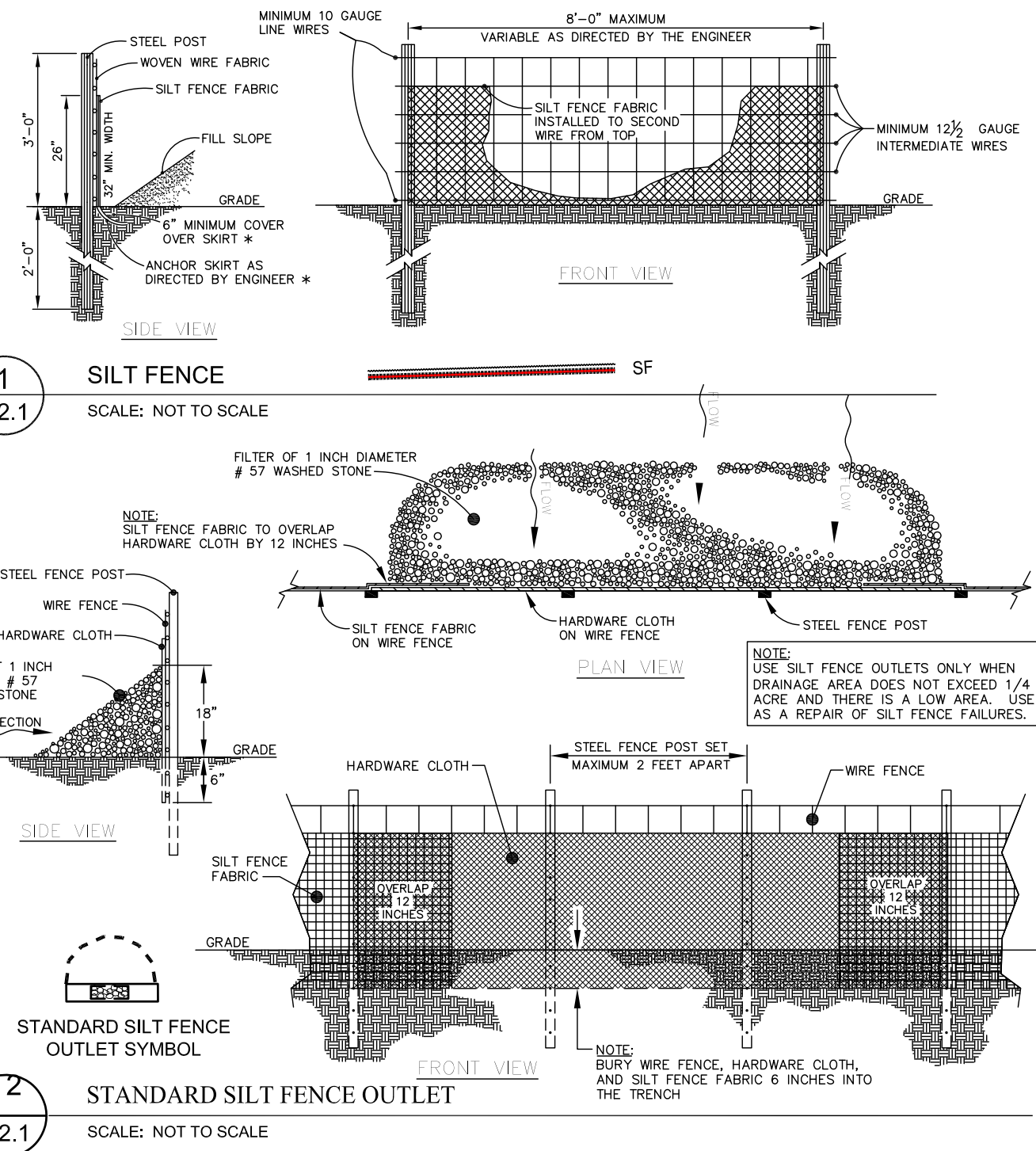

Phase 2 - "Ceremonial Circle - Flagpole"

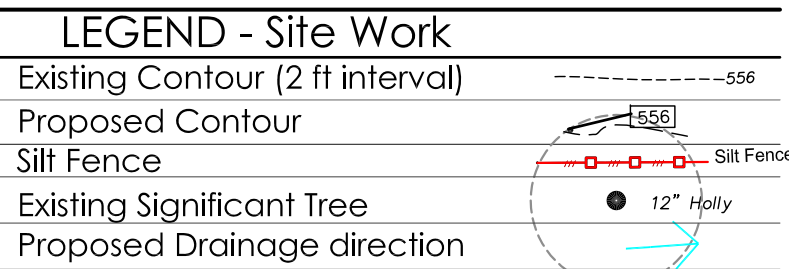

Orange
County
Veterans
Memorial

Orange County
Southern Human
Services Center

Homestead Road
Chapel Hill, NC

April 20, 2018

Grading Plan
Site Access Plan

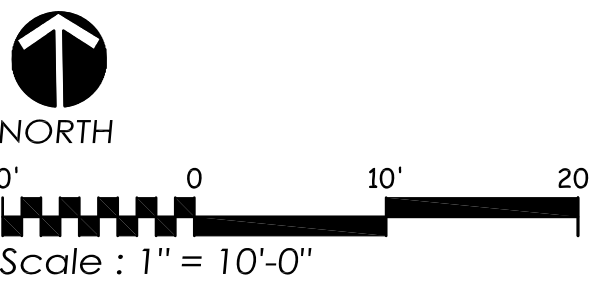

-3.0

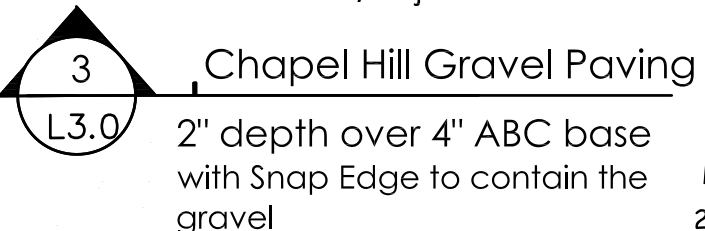



Flagpole Base (precedent example)

Flagpole
min. 50 ft. tall flagpole mounted per manufacturer recommendation. Pole to have internal halyard with both American and N.C. flags. Flagpole to be lighted Base to be bronze star (or similar)

Ceremonial circle
Donor paving to be 4x8 concrete paver blocks and 8x8 Donor Pavers. Concrete pavers to be set on min. 4" ABC base with 2" sand setting bed/screenings with hand-tight joints

Granite Medallions
2" thick granite insignia for five branches of Military and U.S., N.C. and Orange County

Bluestone
1-1/2" thick rectangular cut stone set on concrete base with 1/2" wide mortar joints.

Section



Precedent Example of stone work
Duke stone coursing and inset hidden joints with fully mortared cap.



SWANSON
and ASSOCIATES P.A.
LANDSCAPE ARCHITECTURE
100 E. Carr Street
Carrboro, NC 27510
Ph. (919) 929-9000
info@swansonlandscapearchitecture.com

Danny W. Hassell, LTC
(ret), U.S. Army
ArcLand Designs, L.L.C.

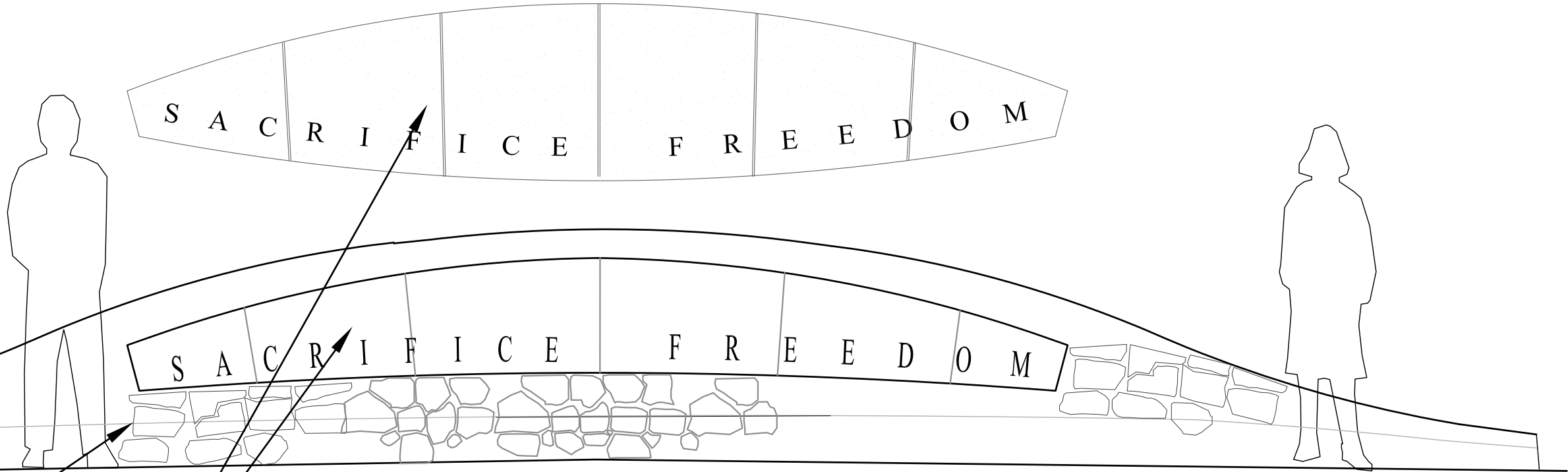

1 Wall Elevation
Scale: 1"=1'-0"

Rock Boulder
native rock to match the Duke Stone

Stone Wall
Wall to slope (batter) on back side to natural grade - top of wall to be ~ 12" wide and follows uniform curve.

Grey granite panel for inscriptions and quotes.
Granite panels to be in segments to follow curve of wall.

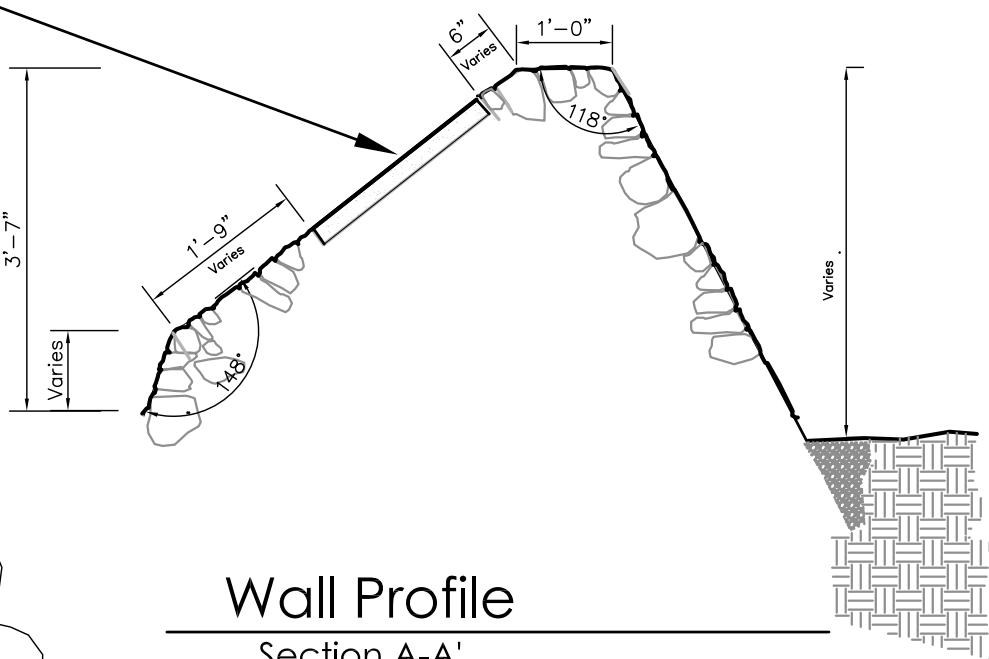

Wall Profile
Section A-A'

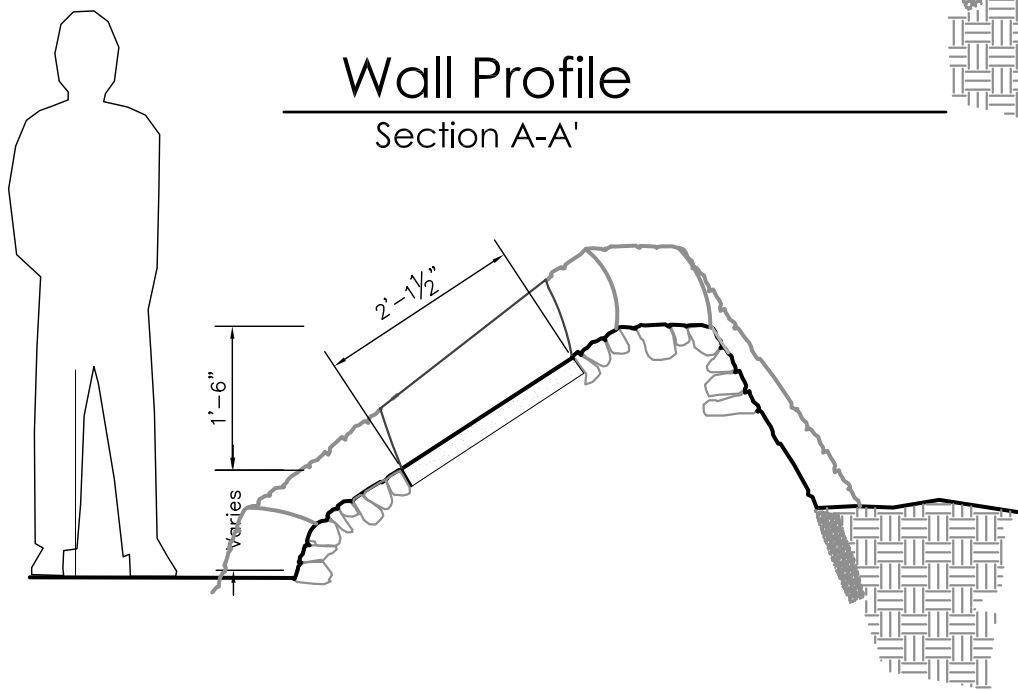

Wall Profile
Section B-B'

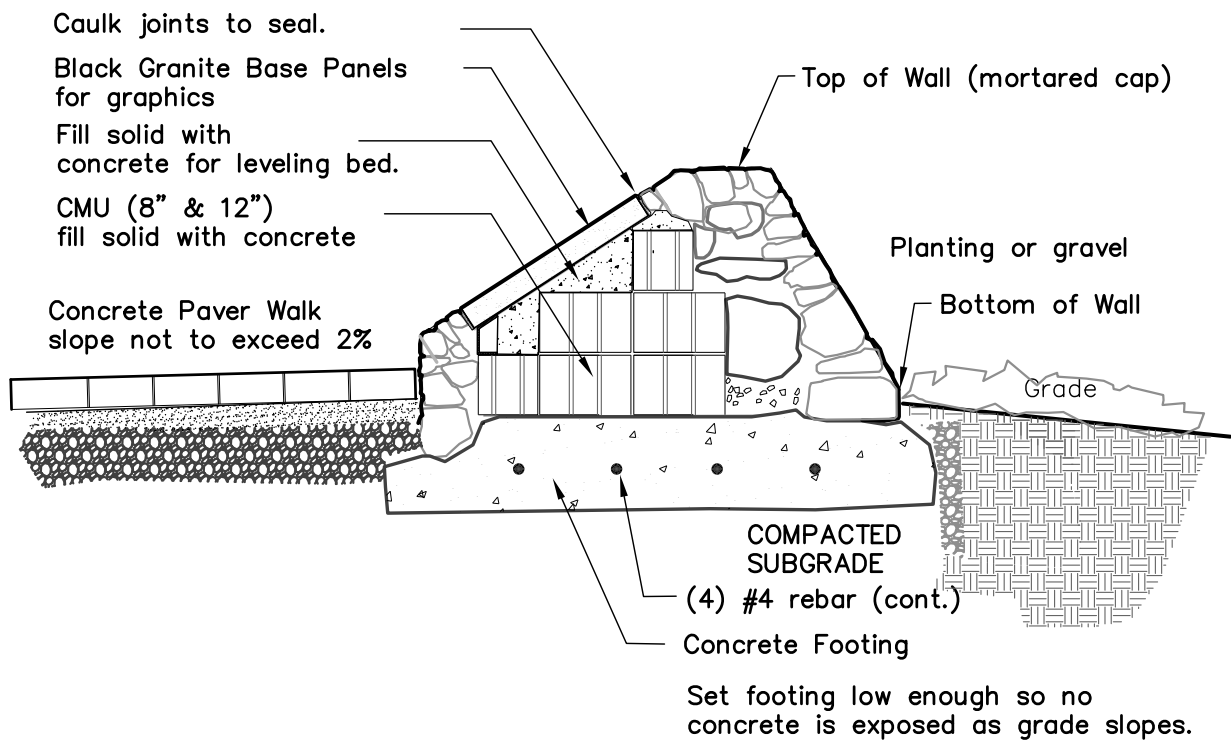

2 Wall Section
Scale: 1"=1'-0"

General Notes:
Stone to match the native Hillsborough 'Duke' Stone stone with flat surfaces. Coursing to be horizontal pattern. Refer to precedent example photos. Build mock-up and/or provide example wall for approval.
Stone wall cap to be set in mortar and sloped to shed water. Provide anchor rocks to 'tie' in the smaller rocks. Set internal portion of the wall with mortar with the dry laid look from the outside.
Flat surfaced faced rock. Maintain about 1/2" wide mortar joints. Use type 'S' mortar. Recess joints by ~ 1/2" and rub clean. Do not allow extra wide areas of mortar to show.

Orange County Veterans Memorial

Orange County Southern Human Services Center

Homestead Road
Chapel Hill, NC

April 20, 2018

Details